

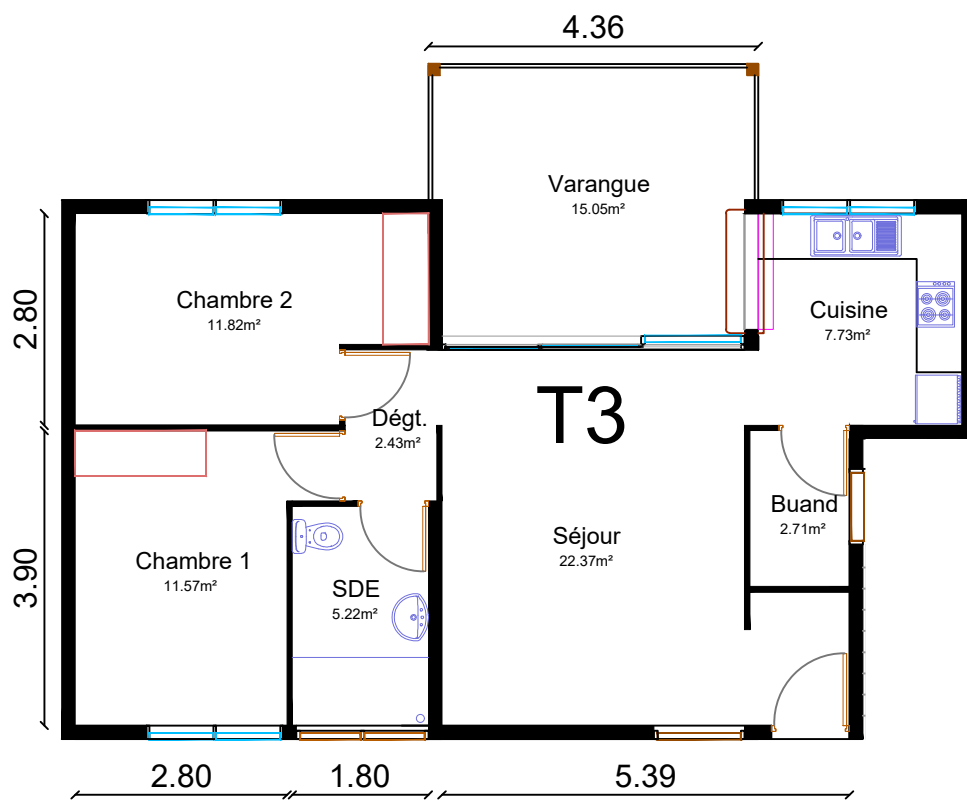

Résidence Évolia - Rémire-Montjoly -

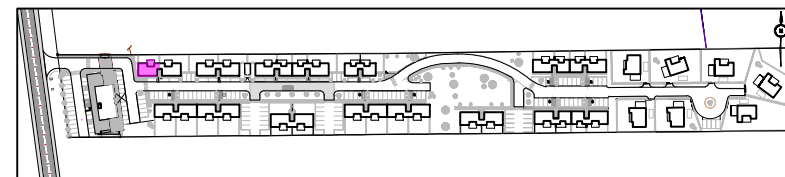

LOT N°11

APPARTEMENT T3 R+1

| | M ² |
|-------------|----------------|
| SEJOUR | 22.37 |
| CUISINE | 7.73 |
| BUANDERIE | 2.71 |
| DEGAGEMENT | 2.43 |
| CHAMBRE 1 | 11.57 |
| CHAMBRE 2 | 11.82 |
| SALLE D'EAU | 5.22 |

TOTAL SH 63.85

VARANGUE V 15.05

TOTAL SH+V 78.90